

## Shoulder Bushing Washer

**Material:** Nylon

**Corrosion Protection Level:** Ultimate

**Finish:** White

**Standard:** HEC Standard

**System Of Measurement:** Metric

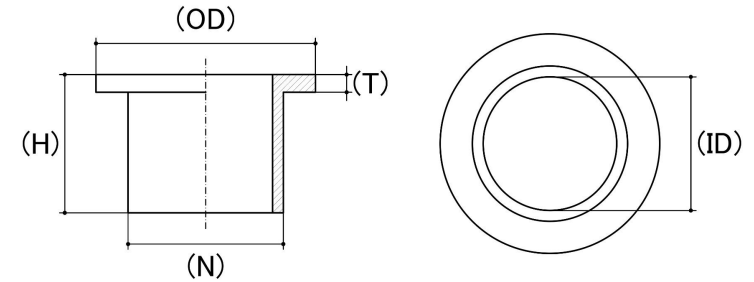

*CAD drawings shown for graphic representation only.\**

Industry Size	Inside Dimension (ID) (mm)		Sleeve Dia (N) (mm)		Height Overall (H) (mm)		Outside Dimension (OD) (mm)		Thickness (T) (mm)		sku (qfind)
	Min	Max	Min	Max	Min	Max	Min	Max	Min	Max	
M5 x 5	5.05	5.15	7.95	8.05	4.95	5.05	14.00	15.00	1.45	1.55	71SWN515
M5 x 8	5.05	5.15	7.95	8.05	7.95	8.05	14.00	15.00	1.45	1.55	71SWN518
M5 x 13	5.05	5.15	7.95	8.05	12.95	13.05	14.00	15.00	1.45	1.55	71SWN5113
M5 x 18	5.05	5.15	7.95	8.05	17.95	18.05	14.00	15.00	1.45	1.55	71SWN5118
M6 x 8	6.00	6.10	8.95	9.05	7.95	8.05	16.00	17.00	1.45	1.55	71SWN68
M6 x 10	6.00	6.10	8.95	9.05	9.95	10.05	16.00	17.00	1.45	1.55	71SWN610
M6 x 13	6.00	6.10	8.95	9.05	12.95	13.05	16.00	17.00	1.45	1.55	71SWN613
M6 x 18	6.00	6.10	8.95	9.05	17.95	18.05	16.00	17.00	1.45	1.55	71SWN618
M6 x 25	6.00	6.10	8.95	9.05	24.95	25.05	16.00	17.00	1.45	1.55	71SWN625
M6 x 35	6.00	6.10	8.95	9.05	34.95	35.05	16.00	17.00	1.45	1.55	71SWN635
M8 x 8	8.05	8.10	10.95	11.05	7.95	8.05	20.00	21.00	1.95	2.05	71SWN818
M8 x 13	8.05	8.10	10.95	11.05	12.95	13.05	20.00	21.00	1.95	2.05	71SWN8113
M8 x 18	8.05	8.10	10.95	11.05	17.95	18.05	20.00	21.00	1.95	2.05	71SWN8118
M8 x 30	8.05	8.10	10.95	11.05	29.95	30.05	20.00	21.00	1.95	2.05	71SWN8130
M10 x 8	9.90	10.00	12.95	13.05	7.95	8.05	23.90	24.70	1.95	2.05	71SWN108

Industry Size	Inside Dimension (ID) (mm)		Sleeve Dia (N) (mm)		Height Overall (H) (mm)		Outside Dimension (OD) (mm)		Thickness (T) (mm)		sku (qfind)
	Min	Max	Min	Max	Min	Max	Min	Max	Min	Max	
M10 x 13	9.90	10.00	12.95	13.05	12.95	13.05	23.90	24.70	1.95	2.05	71SWN1013
M10 x 18	9.90	10.00	12.95	13.05	18.00	18.10	23.90	24.70	1.95	2.05	71SWN1018
M12 x 5	12.05	12.15	14.95	15.05	4.95	5.05	25.90	26.60	2.05	2.15	71SWN1215
M12 x 8	12.05	12.15	14.95	15.05	7.95	8.05	25.90	26.60	2.05	2.15	71SWN1218
M12 x 13	12.05	12.15	14.95	15.05	12.95	13.05	25.90	26.60	2.05	2.15	71SWN12113
M12 x 18	12.05	12.15	14.95	15.05	17.95	18.05	25.90	26.60	2.05	2.15	71SWN12118
M12 x 25	12.05	12.15	14.95	15.05	24.95	25.05	25.90	26.60	2.05	2.15	71SWN12125
M12 x 30	12.05	12.15	14.95	15.05	29.95	30.05	25.90	26.60	2.05	2.15	71SWN12130
M12 x 50	12.05	12.15	14.95	15.05	49.95	50.05	25.90	26.60	2.05	2.15	71SWN12150
M16 x 15	15.90	16.05	18.95	19.05	14.95	15.05	34.80	35.50	2.95	3.05	71SWN1615
M16 x 17	16.10	16.20	18.95	19.05	16.95	17.05	34.80	35.50	2.95	3.05	71SWN16117
M16 x 20	16.10	16.20	18.95	19.05	19.95	20.05	34.80	35.50	2.95	3.05	71SWN16120
M16 x 25	16.10	16.20	18.95	19.05	24.95	25.05	34.80	35.50	2.95	3.05	71SWN16125
M16 x 30	16.10	16.20	18.95	19.05	29.95	30.05	34.80	35.50	2.95	3.05	71SWN16130
M16 x 35	16.10	16.20	18.95	19.05	34.95	35.05	34.80	35.50	2.95	3.05	71SWN16135
M16 x 50	16.10	16.20	18.95	19.05	49.95	50.05	34.80	35.50	2.95	3.05	71SWN16150
M20 x 25	20.40	20.80	22.30	22.70	25.00	25.30	35.80	36.30	2.95	3.05	71SWN20525

**Disclaimer:**

Dimensional data and technical information was obtained from publically available sources and not acquired through standard agencies. It has been completed and compiled for reference purposes only; where discrepancies are found they are subject to change without notice. Bolt & Nut Australia makes no warranties or representations regarding the accuracy and validity of the compiled information and data. Contact the relevant standard authorities for accurate and detailed information.

\* CAD drawings may not reflect diameter, thread length or overall length.

© Bolt & Nut Australia Pty Ltd. All rights reserved.

Version: 18 Mar 2024